



NYU

**ROBERT F. WAGNER GRADUATE
SCHOOL OF PUBLIC SERVICE**

ADMITTED STUDENT DAY

Friday, April 4, 2014

Program



AGENDA

TIME	ACTIVITY	LOCATION
9:00am – 9:30am	Registration	Kimmel Center for University Life (Kimmel), 1st Floor Main Lobby
	Coat and Luggage Check	Kimmel, 10th Floor Lobby
	Breakfast	Kimmel, 10th Floor, Rosenthal Pavilion
9:30am – 9:50am	Welcome and Opening Remarks Sherry Glied , Dean and Professor of Public Service	Kimmel, 10th Floor, Rosenthal Pavilion
	Jane Ellen O’Sullivan , Senior Director, Admissions and Financial Aid	
9:50am – 10:40am	Panel Discussion: Why NYU Wagner? Current Student Perspectives David Schachter , Assistant Dean of Student Affairs and Adjunct Assistant Professor of Public Administration, will lead a discussion with current students about their NYU Wagner experience. Panelists include:	Kimmel, 10th Floor, Rosenthal Pavilion
	<ul style="list-style-type: none">■ Safiya Arnaout, MPA-Health Policy and Management, 2014 Full-time student, Specialization: International Health■ Conor Muldoon, Master of Urban Planning, 2014 Full-time student, Specialization: Economic Development and Housing■ Raquel Vazquez, MPA-Public and Nonprofit Management and Policy, 2015 Part-time student, Specialization: Public Policy Analysis	
10:40am – 11:00am	Break	
11:00am – 12:00pm	WAGTalks <i>In these short talks, four of our premier faculty scholars will present on topics about which they are especially passionate.</i>	Kimmel, 10th Floor, Rosenthal Pavilion
	<ul style="list-style-type: none">■ Beth Simone Noveck, Jacob K. Javits Visiting Professor, “Big Data, Small Data, Open Data” In this brief introduction, we will survey the landscape of how government is and could be using data to create jobs, catalyze innovation, and improve people’s lives. We’ll talk about the pragmatic, positive, and purposeful things we can affirmatively do with data and examine the question of how data complements and substitutes for traditional forms of policymaking.	

- **Karen Grépin**, Assistant Professor of Global Health Policy, “Is educating girls the fastest way to improve child health in the developing world today?”

Improving health and education in the developing world are important priorities for the international community and both are targets in the Millennium Development Goals. Research from Zimbabwe suggests that improving access to maternal secondary education can greatly improve child survival. In the post-2015 world, we will argue that one of the most important untapped interventions to improving child health might be improving access to secondary schools.

- **Nirupama Rao**, Assistant Professor of Economics and Public Policy, “The 47 or 67 Percent? Makers, Takers, and the Lifecycle of Tax Liabilities”

The fact that 47 percent of Americans paid no federal income taxes in 2011 drew considerable attention during the most recent presidential election cycle. Whether not paying federal taxes and/or receiving transfer benefits is symptomatic of a culture of dependency, where the federal government is in effect subsidizing the obsolescence of skills and labor force dis-attachment, depends in part on how chronic these states are. We will examine how individuals enter and leave these states over their lifetimes.

- **Mitchell L. Moss**, Henry Hart Rice Professor of Urban Policy & Planning, “The Future of New York”

How will new information technologies, demographic trends, and global forces shape the future of New York City? The city faces new challenges in the 21st century, and this talk will explore why New York is a magnet for people from across the nation and world, and factors that will influence its future economic and physical development.

12:00pm – 1:30pm

Lunch by Degree Program or Specialization

Enjoy lunch with the faculty director of your degree program or specialization, current students, staff, and other admitted students.

MPA - Public and Nonprofit Policy and Management

Hosted by **Joe Magee**, Associate Professor of Management and Director of the Public and Nonprofit Policy and Management Program

Other participating faculty include:

Gordon J. Campbell, Professor of Practice and Director of Executive MPA Program for Public Service Leaders and Managers

Erica Gabrielle Foldy, Associate Professor of Public and Nonprofit Management and Director of Management Specializations

Shankar Prasad, Clinical Professor

Nirupama Rao, Assistant Professor of Economics and Public Policy

Amy Ellen Schwartz, Professor of Public Policy, Education, and Economics

Dennis C. Smith, Associate Professor of Public Policy

Rachel Swaner, Adjunct Assistant Professor of Public Administration

**Kimmel, 10th Floor,
Rosenthal Pavilion**

TIME	ACTIVITY	LOCATION
	<p>MPA - Health Policy and Management Hosted by John Billings, Professor of Health Policy and Public Service and Director of the Health Policy and Management Program</p> <p><i>Other participating faculty include:</i> Jan Blustein, Professor of Health Policy and Professor of Medicine Karen Grépin, Assistant Professor of Global Health Policy Victor G. Rodwin, Professor of Health Policy and Management</p>	<p>Global Center for Academic and Spiritual Life, 2nd Floor, Room 269</p>
	<p>Master of Urban Planning Hosted by Ingrid Gould Ellen, Paulette Goddard Professor of Urban Policy and Planning and Director of the Urban Planning Program</p> <p><i>Other participating faculty include:</i> Zhan Guo, Assistant Professor of Urban Planning and Transportation Policy Mitchell L. Moss, Henry Hart Rice Professor of Urban Policy and Planning Tim Tompkins, Adjunct Assistant Professor of Urban Planning</p> <p><i>Participating alumni include:</i> Sally Greenspan, Master of Urban Planning, 2011 Senior Program Officer, Enterprise Community Partners Alex Lieber, Master of Urban Planning, 2012 Planner, AKRF, Inc. Gwen Litvak, Master of Urban Planning, 2010 Policy Advisor, Resiliency Team at NYC Mayor’s Office of Long-Term Planning and Sustainability</p>	<p>Global Center for Academic and Spiritual Life, 2nd Floor, Room 279</p>
	<p>International Specializations Hosted by John Gershman, Clinical Associate Professor of Public Service and Director of International Programs</p> <p><i>Participating alumni include:</i> David Algoto, MPA-Public and Nonprofit Management and Policy, 2011 Director of Programs at ReBoot Rebecca Bavinger, MPA-Public and Nonprofit Management and Policy, 2012 Co-founder and Program Officer, Global Public Health Department, Bloomberg Philanthropies</p>	<p>Kimmel, 9th Floor, Room 905-907</p>
<p>1:30pm – 1:45pm</p>	<p>Break</p>	<p>Kimmel, 10th Floor, Rosenthal Pavilion</p>

TIME	ACTIVITY	LOCATION
1:45pm – 2:30pm	<p>Panel Discussion: Why NYU Wagner? Alumni Perspectives Surabhi Lal, Director of Career and Alumni Services, will lead a discussion with alumni about their NYU Wagner experience and how it prepared them for work in their field. Panelists include:</p> <ul style="list-style-type: none"> ■ Shari Hinds, MPA-Health Policy and Management, 2011 Program Manager, Training and Development Department, NYC Health and Hospitals Corporation at Coney Island Hospital ■ Ben Winter, Master of Urban Planning, 2009 Policy Development Analyst, U.S. Department of Housing and Urban Development ■ Kenneth Wong, MPA-Public and Nonprofit Management and Policy, 2004 Director of Special Events, Empire State Development Corporation 	Kimmel, 10th Floor, Rosenthal Pavilion
2:30pm – 2:50pm	<p>Break <i>Grab an afternoon cup of coffee or tea, gather your belongings from coat check, and connect with your group in preparation for the campus walking tour.</i></p>	Kimmel, 10th Floor, Rosenthal Pavilion
2:30pm – 2:50pm	<p>WagnerCares Day of Service Briefing <i>Prior to the campus walking tour, those who previously registered for the Day of Service on Saturday, April 5 will meet for a short briefing about the next day's service activities.</i></p>	Kimmel, 9th Floor, Room 909
2:50pm – 3:30pm	<p>Campus Walking Tour <i>A current student will lead you and fellow admitted students on a tour of the NYU campus through the heart of NYC's famed Greenwich Village, eventually making your way to NYU Wagner's home at the historic Puck Building in the SoHo neighborhood.</i></p>	NYU Campus
3:30pm – 4:30pm	<p>Faculty-led Course Overview Table Discussions <i>In this version of speed-dating, you'll have the chance to learn more about three courses from the professors who teach them. See pages 12-13 for a list of courses and professors.</i></p>	The Puck Building, 295 Lafayette St., 2nd Floor, Rudin Family Forum for Civic Dialogue
4:30pm – 4:50pm	<p>Closing Remarks Sherry Glied, Dean and Professor of Public Service Jane Ellen O'Sullivan, Senior Director, Admissions and Financial Aid Ashley Kolaya, MPA-Public and Nonprofit Management and Policy, 2014 Full-time student, Specialization: Management Wagner Student Association (WSA) President (2013 - 2014) Leadership + Organizational Development Consultant at Etsy</p>	The Puck Building, Rudin Family Forum for Civic Dialogue
5:00pm	<p>NYU Wagner Student Happy Hour <i>Join current students and fellow admitted students for happy hour, organized by the Wagner Philanthropy and the Wagner Management and Leadership Organization student groups. One complimentary drink ticket is included in your registration materials.</i></p>	Sláinte, 304 Bowery

PARTICIPATING ADJUNCT FACULTY

For a complete list of our full-time and clinical faculty, including those participating in Admitted Student Day, please refer to the Admitted Student Handbook, Ready for Transformation.

ADJUNCT FACULTY

Diana Beck

Adjunct Assistant Professor of Public Administration

Diana Beck is the Assistant Director of Health and Doctoral Programs at NYU Wagner and is the primary administrative advisor for these programs. Previously, Diana was an Associate Research Scientist at the Center for Health and Public Service Research where she worked on several projects relating to performance of the health care delivery system, barriers to access to care, and longitudinal analyses of hospital admissions and emergency department utilization. Diana is also an adjunct professor at NYU Wagner.

Carolyn A. Berry

Adjunct Associate Professor of Public Administration

Carolyn Anne Berry holds a Ph.D. in Community Psychology from New York University. Her current research focuses on the health and healthcare of low-income children and families, and includes both investigator-initiated research and program evaluation. She recently concluded a five year grant from the National Institute of Environmental Health Sciences (NIEHS) entitled "Social Factors and the Environment in Pediatric Asthma" that investigates racial/ethnic disparities in childhood asthma. Carolyn conducted an outcome evaluation of the SchoolFood Plus Initiative, a program designed to enhance the nutrition of children in the NYC public school system.

Carolyn and Dr. Dennis Smith are in the final stages of a process study of WeCARE, a recently implemented program designed to provide specialized assessments and services to the public assistance population that is unable to work immediately. That program and study are funded by the NYC Department of Social Services/Human Resources Administration. Carolyn is part of an NYU Wagner team working on the national evaluation of "Expecting Success," a demonstration project funded by the Robert Wood Johnson Foundation to address disparities in cardiac health care at 10 hospitals with large volumes of racial and ethnic minorities.

Irshad Manji

Founder & Director, Moral Courage Project

Irshad Manji is the Founder and Director of the Moral Courage Project, which equips students to make values-based decisions. She has turned her journey as a religious reformer into teachings about professional leadership, informed by cutting-edge research from across disciplines.

As a reformist Muslim, Irshad puts moral courage into practice. Her latest book, *Allah, Liberty & Love*, is a guide to reconciling faith and freedom in a world raging with repressive dogmas. Fareed Zakaria of CNN and *Time* magazine lauds *Allah, Liberty & Love* as being "at the forefront of some crucially important trends" that are "changing the world of Islam." Irshad's previous book is the international bestseller *The Trouble with Islam Today: A Muslim's Call for Reform in Her Faith*. In-between her books, she created the Emmy-nominated PBS documentary *Faith Without Fear*.

In both the business and nonprofit arenas, Irshad's work has earned high recognition. The World Economic Forum named her as a Young Global Leader. The New York Society for Ethical Culture gave her its rare Ethical Humanist Award. And Oprah Winfrey bestowed on Irshad the first annual Chutzpah Award for "audacity, nerve, boldness and conviction."

David Schachter

Assistant Dean for Student Affairs and Adjunct Assistant Professor of Public Administration

David Schachter is the Assistant Dean for Student Affairs at NYU Wagner. Focusing on the totality of the student experience, he oversees student and program services, career services, alumni relations, and the Capstone program. He teaches the Composing Your Career workshop, and he has offered training, consulting, and facilitation nationally in the areas of leadership, staff development, supervision, team building, training of the trainer, and career planning. David received the 2006 NACE/Chevron Outstanding Achievement Award for Innovative Programs in Career Services for his partnership with Action Without Borders/Idealist.org on the creation of the Institute on Public Service Careers, a series of conferences designed to educate college career services professionals from across the country on how to increase the visibility and accessibility of public service careers to their students. He has served on the Idealist.org advisory

PARTICIPATING ADJUNCT FACULTY

board and contributed to *The Idealist Guide to Nonprofit Careers* and *The Idealist Guide to Nonprofit Careers for Sector Switchers*. David received his Master of Public Administration from NYU Wagner and a BFA from NYU's Tisch School of the Arts.

Rachel Swaner

Adjunct Assistant Professor of Public Administration

Rachel Swaner is Associate Director of Research at the Center for Court Innovation. She is currently the project director of the evaluation of the Defending Childhood Initiative, a U.S. Department of Justice multi-site initiative to address children's exposure to violence. She is also the research coordinator for a study on youth engaged in the commercial sex market, and evaluated a gun violence reduction program in Brownsville, Brooklyn. She was previously a researcher and evaluator at Harlem Children's Zone. She is on the advisory board for the Participatory Budgeting Project. Rachel received her Ph.D. in Sociology from the CUNY Graduate Center, and her Bachelor of Science and Master of Public Administration from New York University.

Scott Taitel

Adjunct Associate Professor of Finance

Scott Taitel is Chief Operating Officer for the William J. Clinton Foundation's Clinton Giustra Sustainable Growth Initiative. As Chief Operating Officer, Mr. Taitel is responsible for the financial, operational, and project management oversight of economic development, health, and nutrition projects in multiple countries, including Colombia, Mexico, and Peru. Scott also oversees impact investment funds in both Colombia and Haiti. Prior to joining the William J. Clinton Foundation, Mr. Taitel was a Managing Partner of Waypoint Investments, a venture capital firm, where he managed an international investment portfolio and served in interim management roles in portfolio companies.

His prior experience also includes roles as Chief Operating Officer for TASKING B.V., a Netherlands-based software company with operations in six countries; CFO and Vice President of Active Control eXperts, an Inc. 500 OEM manufacturer of piezoelectric motion control devices; and Vice President of Intermetrics Microsystems Software, Inc., a software developer with operations in the U.S., Europe, and Asia. His earlier career was as an economic development planner with both City and

Community Action Agencies. Scott has an undergraduate degree in Policy Studies from Syracuse University and an MBA from Northeastern University where he taught various Financial Management courses for 15 years as an adjunct faculty member.

Tim Tompkins

Adjunct Assistant Professor of Urban Planning

Tim Tompkins has been the President of the Times Square Alliance since 2002. He is currently the Co-Chair of the NYC BID Association and a member of the International Downtown Association (IDA) Board. Prior to joining the Alliance, he was the Founder and Director of Partnerships for Parks, which works to support New York City's neighborhood parks and which won an Innovations in Government Award from the JFK School of Government at Harvard University for its work to restore the Bronx River.

He has also worked at New York City's Economic Development Corporation, The New York City Charter Revision Commission, and was briefly the Nationals Editor at the *Mexico City News*, an English language newspaper in Mexico. He has an undergraduate degree from Yale and an M.B.A. from Wharton, and currently teaches Transforming the Urban Economy and The Arts and Artist in Urban Revitalization at NYU Wagner. When not in the most urban and unnatural place on the planet, he enjoys spending time in New York's more natural areas, ideally sailing or practicing yoga.

Michael West

Adjunct Lecturer on Public Administration

Michael West is Department Manager for the Department of Sociology at NYU. He has previously served in the Provost's Office at NYU, where he developed services and programming for special populations at the University, and as the Chief of Staff in the Business Office at Hunter College, which is part of the City University of New York. He holds an M.P.A. in Nonprofit Management and Policy from the Wagner Graduate School of Public Service at NYU and an M.A. in Higher Education and Student Personnel Administration from the Steinhardt School of Culture, Education, and Human Development at NYU. He has over 10 years of professional experience in higher education administration and financial management, and is interested in not-for-profit fiscal decision-making and policy, as well as financial statement analysis.

PARTICIPATING CURRENT STUDENTS

Wemimo Abbey

MPA-Public and Nonprofit Management and Policy
Specialization: International

Rasheida Alston

MPA-Public and Nonprofit Management and Policy
Specialization: Finance

Simone Andrews

MPA-Public and Nonprofit Management and Policy
Specialization: Management

Safiya Arnaut

MPA-Health Policy and Management
Specialization: International

Lydia Avila

MPA-Public and Nonprofit Management and Policy
Specialization: Management

Julissa Baez

MPA-Public and Nonprofit Management and Policy
Specialization: Management

Bridgette Blair

Executive MPA

Corey Blay

Dual degree: MPA-MBA (Master of Business Administration)

Leda Bloomfield

Master of Urban Planning
Specialization: Economic Development and Housing

Vanessa Bobadilla

Dual degree: MPA-MPH (Master of Public Health)
Specialization: Policy

Grace Boone

MPA-Public and Nonprofit Management and Policy
Specialization: Policy

Tatiana Bryant

MPA-Public and Nonprofit Management and Policy
Specialization: International

Christian Carreno

MPA-Public and Nonprofit Management and Policy
Specialization: Management

Anisha Chikarmane

MPA-Health Policy and Management
Specialization: Finance

Adam Cross

MPA-Public and Nonprofit Management and Policy
Specialization: Management

Danielle Cummings

MPA-Health Policy and Management
Specialization: Policy

Cate Dangremond

MPA-Health Policy and Management
Specialization: Policy

Melika Edquist

MPA-Public and Nonprofit Management and Policy
Specialization: International Policy and Management

Namon Freeman

Master of Urban Planning
Specialization: International Development Planning

Estee Gabel

MPA-Public and Nonprofit Management and Policy
Specialization: Finance

Keely Gerhold

MPA-Public and Nonprofit Management and Policy
Specialization: International

Gelila Getaneh

MPA-Public and Nonprofit Management and Policy
Specialization: International Policy

Krystal Gittens

Master of Urban Planning
Specialization: Environment, Infrastructure, and Transportation

Lillian Gordon-Koven

Master of Urban Planning
Specialization: Environment, Infrastructure, and Transportation

Safia Gulamani

MPA-Public and Nonprofit Management and Policy
Specialization: International

Meghan Haenn

MPA-Public and Nonprofit Management and Policy
Specialization: Finance

Adam Heidbreder

MPA-Public and Nonprofit Management and Policy
Specialization: International Policy

Kirk Hovenkotter

MPA-Public and Nonprofit Management and Policy
Specialization: Policy

Courtney Jones

MPA-Public and Nonprofit Management and Policy
Specialization: Policy

Harold Jones

MPA-Health Policy and Management
Specialization: Finance

Julie Kim

MPA-Public and Nonprofit Management and Policy
Specialization: Management

Jennifer Kitson

MPA-Public and Nonprofit Management and Policy
Specialization: International

Ashley Kolaya

MPA-Public and Nonprofit Management and Policy
Specialization: Management

James Kostenblatt

MPA-Public and Nonprofit Management and Policy
Specialization: Management

Allison Kroner

MPA-Public and Nonprofit Management and Policy
Specialization: Management

Charlotte Laffler

Master of Urban Planning
Specialization: Economic Development and Housing

Richard Laraway

MPA-Public and Nonprofit Management and Policy
Specialization: Management

PARTICIPATING CURRENT STUDENTS

Anita Lederer

MPA-Public and Nonprofit Management and Policy
Specialization: International

Alexandra Levine

Master of Urban Planning
Specialization: Economic Development and Housing

Kelsey Liddy

MPA-Public and Nonprofit Management and Policy
Specialization: Finance

Moe Magali

MPA-Public and Nonprofit Management and Policy
Specialization: Management

Andres Martinez

MPA-Public and Nonprofit Management and Policy
Specialization: International

Flora Mendoza

MPA-Public and Nonprofit Management and Policy
Specialization: Management

Conor Muldoon

Master of Urban Planning
Specialization: Economic Development and Housing

Ellen Nadeau

MPA-Public and Nonprofit Management and Policy
Specialization: International

Jessica Nagro

MPA-Health Policy and Management
Specialization: Policy

Keita Nishimura

MPA-Public and Nonprofit Management and Policy
Specialization: Management

Ryan Norton

MPA-Public and Nonprofit Management and Policy
Specialization: International

Rebekah O'Donoghue

MPA-Public and Nonprofit Management and Policy
Specialization: Policy

Bernard Ortega

MPA-Health Policy and Management
Specialization: Policy

Samik Patel

MPA-Health Policy and Management
Specialization: Management

Liz Petoskey

MPA-Public and Nonprofit Management and Policy
Specialization: International

Alex Powell

Master of Urban Planning
Specialization: Economic Development and Housing

Ashley Putnam

MPA-Public and Nonprofit Management and Policy
Specialization: International

Emily Rhodes

Master of Urban Planning
Specialization: Economic Development and Housing

Karla Robles

MPA-Public and Nonprofit Management and Policy
Specialization: Management

Tracy Rodrigues

Master of Urban Planning
Specialization: International
Development Planning

Laura Romanosky

MPA-Public and Nonprofit Management and Policy
Specialization: Management

Kelsey Sagawa

MPA-Public and Nonprofit Management and Policy
Specialization: Policy

David Sangokoya

MPA-Public and Nonprofit Management and Policy
Specialization: International

Chandan Sharma

MPA-Public and Nonprofit Management and Policy
Specialization: Policy

Tyeshia Smith

MPA-Public and Nonprofit Management and Policy
Specialization: International

Rachel Szala-Grant

MPA-Public and Nonprofit Management and Policy
Specialization: Management

Austin Turner

MPA-Public and Nonprofit Management and Policy
Specialization: Finance

Raquel Vazquez

MPA-Public and Nonprofit Management and Policy
Specialization: Policy

Nicole Vecchione

MPA-Public and Nonprofit Management and Policy
Specialization: Policy

Aayesha Vichare

MPA-Health Policy and Management
Specialization: International

Amanda Warco

MPA-Public and Nonprofit Management and Policy
Specialization: Policy

David Warnock

MPA-Public and Nonprofit Management and Policy
Specialization: Finance

Perry Wong

MPA-Public and Nonprofit Management and Policy
Specialization: Management

Selwyn Yeh

MPA-Public and Nonprofit Management and Policy
Specialization: Management

KIMMEL CENTER FOR UNIVERSITY LIFE

9TH FL



10TH FL

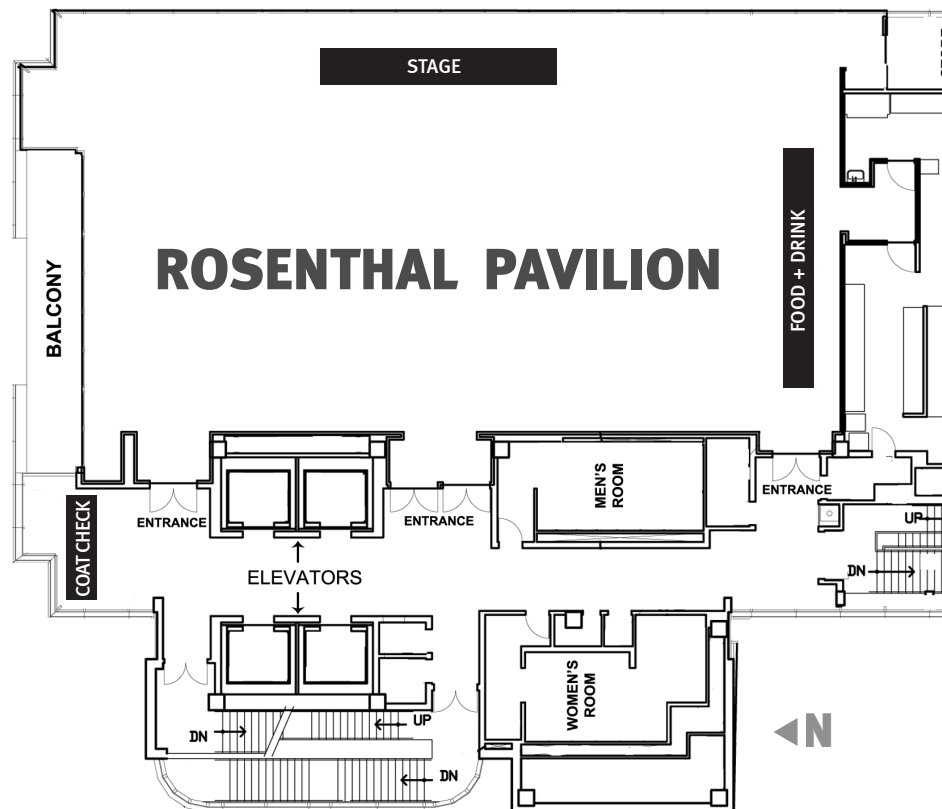

GLOBAL CENTER FOR ACADEMIC & SPIRITUAL LIFE

2ND
FL

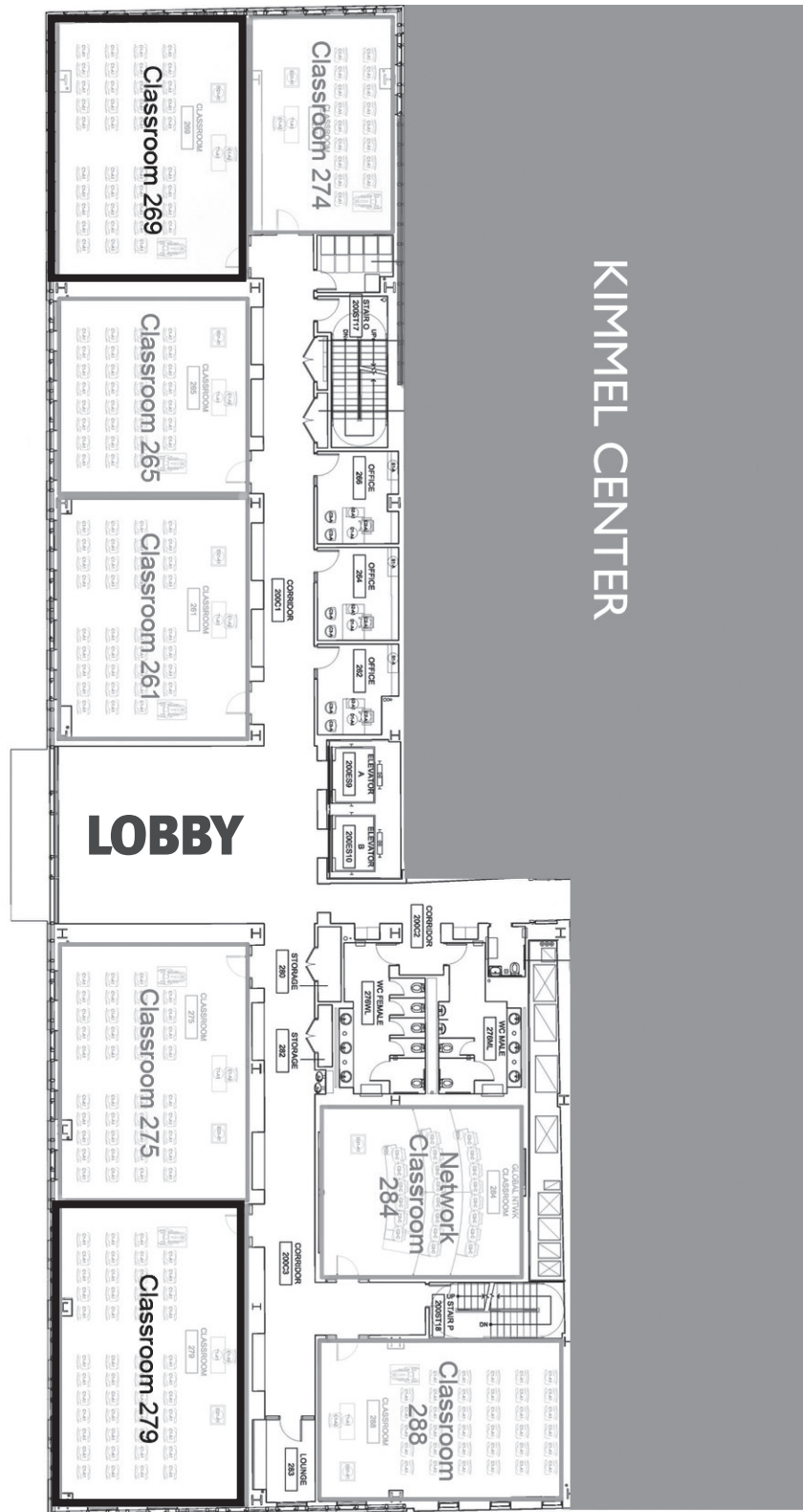

KIMMEL CENTER



COURSE OVERVIEW DISCUSSIONS: PARTICIPATING FACULTY

See page 13 for a map of corresponding tables.

1. Program Analysis and Evaluation (PADM-GP 2171)

Carolyn A. Berry, Adjunct Associate Professor of Public Administration

2. Current Issues in Health Policy (HPAM-GP 2836)

John Billings, Professor of Health Policy and Public Service and Director of the Health Policy and Management Program

3. Estimating Impacts in Policy Research (PADM-GP 2875)

Jan Blustein, Professor of Health Policy and Professor of Medicine

4. The Intersection of Operations and Policy: A Multimedia Learning Experience in the New York City Family Homeless Shelter System (PADM-GP 2174)

Gordon J. Campbell, Professor of Practice and Director of Executive MPA Program for Public Service Leaders and Managers

5. Public Economics and Finance (PADM-GP 2140)

Sewin Chan, Associate Professor of Public Policy

6. Institutions, Governance, and International Development (PADM-GP 2201)

Salo Vinocur Coslovsky, Assistant Professor of International Development

7. International Economic Development (PADM-GP 2203)

Rajeev Dehejia, Associate Professor of Public Policy

8. Community Organizing (PADM-GP 2106)

David Elcott, Henry and Marilyn Taub Foundation Professor of Practice in Public Service and Leadership

9. Urban Economics (URPL-GP 2608)

Ingrid Gould Ellen, Paulette Goddard Professor of Urban Policy and Planning and Director of the Urban Planning Program

10. Race, Identity, and Inclusion in Organizations (PADM-GP 2129)

Erica Gabrielle Foldy, Associate Professor of Public and Nonprofit Management and Director of Management Specializations

11. Hunger and Food Security in a Global Perspective (PADM-GP 4250)

John Gershman, Clinical Associate Professor of Public Service and Director of International Programs

12. Health Economics: Topics in Domestic Health Policy (HPAM-GP 4831)

Sherry Glied, Dean and Professor of Public Service

13. Planning Practice and Methods (URPL-GP 1603)

Zhan Guo, Assistant Professor of Urban Planning and Transportation Policy

14. Managing Public Service Organizations (CORE-GP 1020)

Joe Magee, Associate Professor of Management and Director of the Public and Nonprofit Policy and Management Program

15. Moral Courage and Your Purpose (PADM-GP 2196)

Irshad Manji, Founder & Director, Moral Courage Project

16. Statistical Methods for Public, Nonprofit, and Health Management (CORE-GP 1011)

Shankar Prasad, Clinical Professor

17. Introduction to Health Policy and Management (HPAM-GP 1830)

Victor G. Rodwin, Professor of Health Policy and Management

18. Introduction to Public Policy (CORE-GP 1022)

Dennis C. Smith, Associate Professor of Public Policy

19. The Economics of Education: Policy and Finance (PADM-GP 2441)

Leanna Stiefel, Professor of Economics

20. Financial Management for International Organizations (PADM -GP 2242)

Scott Taitel, Adjunct Associate Professor of Finance

21. Transformation of the Urban Economy: Case Studies (URPL-GP 2452)

Tim Tompkins, Adjunct Assistant Professor of Urban Planning

22. Financial Management for Public, Nonprofit, and Health Organizations (CORE-GP 1021)

Michael West, Adjunct Lecturer on Public Administration

23. Planning for Emergencies and Disasters (URPL-GP 2645)

Rae Zimmerman, Professor of Planning and Public Administration

COURSE OVERVIEW DISCUSSIONS: TABLE MAP

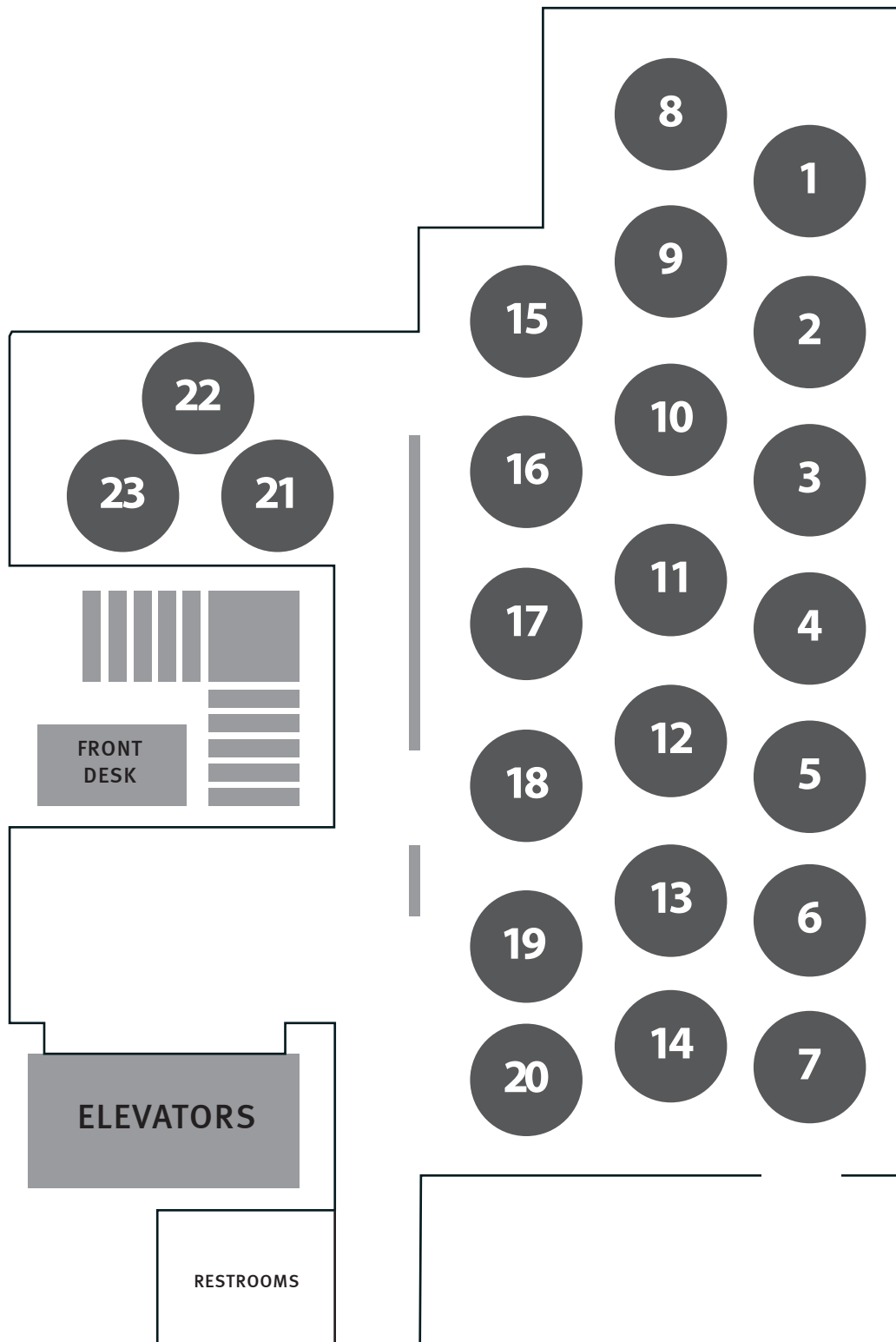



NYU

**ROBERT F. WAGNER GRADUATE
SCHOOL OF PUBLIC SERVICE**

**The Puck Building
295 Lafayette Street, 2nd Floor
New York, NY 10012
wagner.nyu.edu**

© 2014